

URA ONE

indoor self-contained emergency lighting luminaire LED

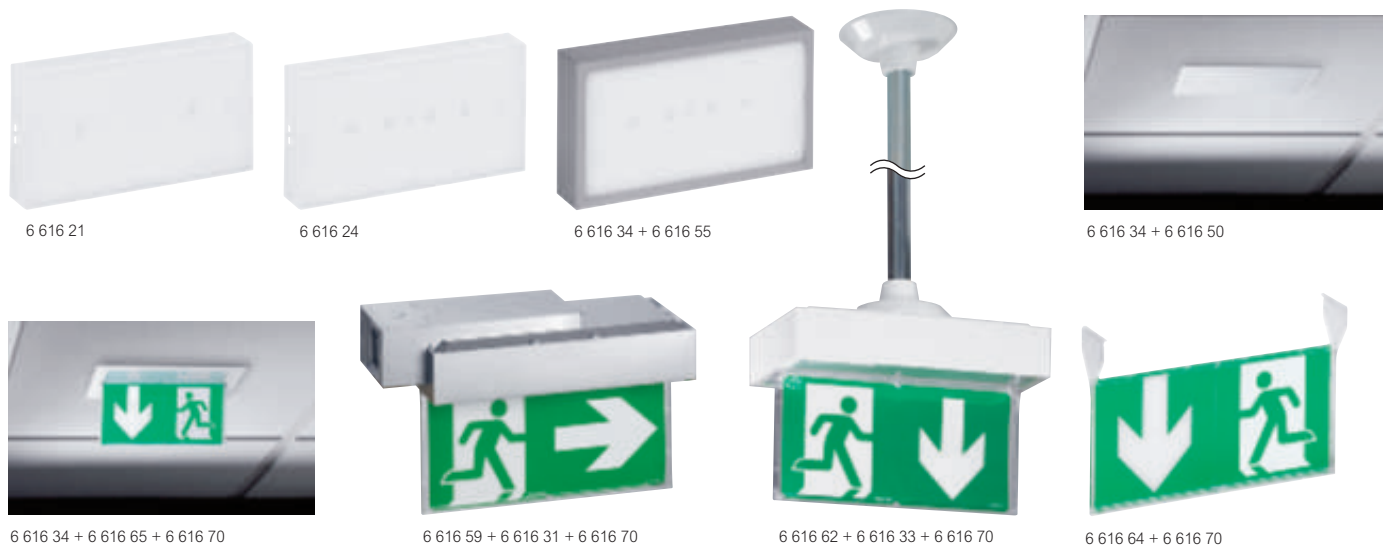

Spare batteries selection chart **p. 691**
 Technical characteristics **p. 682**
 Adhesive labels **p. 690**

LED non-maintained and maintained units
 Certified to IEC and EN 60598-2-22 standards
 High power LEDs with optimized lighting distribution
 Low consumption switching power supply. Fully recyclable
 Plug-in back with pre-cutted holes grid to ease installation and maintenance
 Automatic terminals with high capacity: 2 x 2.5 mm². IP 42 - IK 07
 Duration: 1 and 3 hours. Ni-Cd or Ni-MH batteries. Recharge time: 24 hours
 Charge monitor with a green LED. Opal diffuser
 Power supply: 230 V \sim \pm 10% - 50/60 Hz. Class II \square
 Flat flush-mounting integration into ceiling & wall with flush-mounting frame Cat.Nos 6 616 50/51
 Decorative frame to enhance surface-mounting aesthetic integration Cat.Nos 6 616 54/55

Pack	Cat.Nos	Standard luminaires	Pack	Cat.Nos	Accessories
		Require normal lighting manual switching off in order test emergency lighting			
		Non-maintained			Decorative frame for surface-mounting installation
1	6 616 20	70 lm - 1h (LEDs)	1	6 616 54	White colour
1	6 616 21	100 lm - 1h (LEDs)	1	6 616 55	Aluminium colour
1	6 616 22	160 lm - 1h (LEDs)			Slim flush-mounting frame for false ceiling and dry partition
1	6 616 23	200 lm - 1h (LEDs)	1	6 616 50	White colour
1	6 616 24	350 lm - 1h (LEDs)	1	6 616 51	Aluminium colour
		Maintained/Non-maintained (M/NM)			Flag-mounting accessory
		Can also operate in Non-maintained mode according to the wiring of normal lighting	1	6 616 58	White colour
1	6 616 31	100 lm - 1h (LEDs)	1	6 616 59	Aluminium colour
1	6 616 32	160 lm - 1h (LEDs)			Suspension mounting accessory
1	6 616 33	200 lm - 1h (LEDs)	1	6 616 62	White colour
1	6 616 34	350 lm - 1h (LEDs)	1	6 616 63	Aluminium colour
1	6 616 40	100 lm - 3h (LEDs)			Signalling plate
		Autotest & addressable luminaires - Maintained/Non-maintained (M/NM)	1	6 616 64	Vertical transparent plate for evacuation signalling (must be completed with adhesive evacuation label)
		Autotest/addressable luminaires incorporate an automatic self-testing system in order to check the emergency mode			Flush-mounting frame
		Tests result is visible on 2 signalling LEDs (green-OK and yellow-defective)	1	6 616 65	Special frame with vertical signalling plate
		Addressable function is activated by setting an ID on each luminaire with infrared configuration tool (Cat.No 0 626 10) and wiring a complementary BUS line. Operating state of all addressable luminaires can be centralized by the control interface (Cat.No 0 626 00) and monitored on a local touch screen controller (Cat.No 0 626 01), or with the building's plan on Legrand Vision System (LVS2) PC software (Cat.No 0 626 02)			
		These Maintained luminaires can also operate in Non-maintained mode according to the wiring of normal lighting			
1	6 626 31	100 lm - 1h (LEDs)			
1	6 626 33	200 lm - 1h (LEDs)			
1	6 626 34	350 lm - 1h (LEDs)			
1	6 626 40	100 lm - 3h (LEDs)			